

## 调心滚子轴承-退卸套

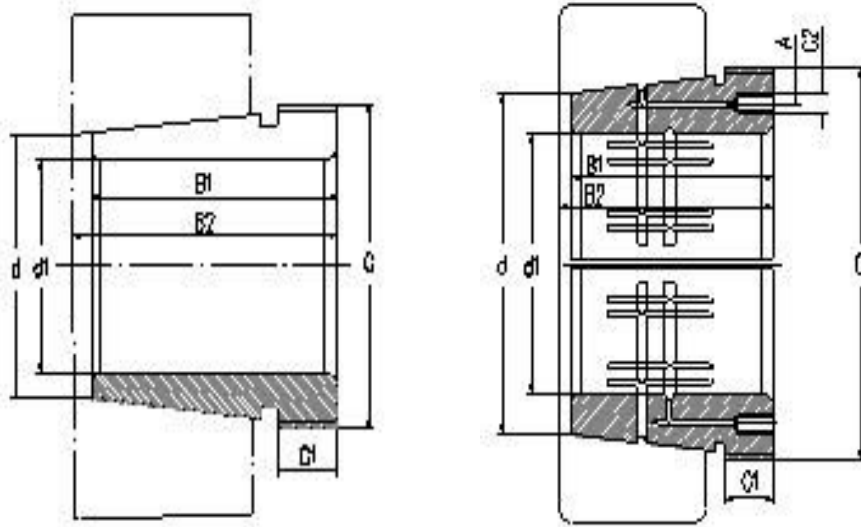

基本尺寸								型号退卸套	退卸时适用的螺母	适用的液压螺母	重量
95	100	64	68	M110×2	11			AH3120	KM22	HMV22E	0.66
1010	1060	310	328	Tr1095×8	50	G1/4	15	AOH239/1060			261
105	110	65	72	M120×2	11			AH3122			0.76
145	150	96	101	M160×3	15			AHX3130	KM32	HMV32E	1.8
170	180	105	110	M200×3	17			AH2236	KM40		3.4
170	180	116	122	M190×3	19			AHX3136	KM38	HMV38E	4.25
200	220	130	136	Tr240×4	20			AH2244			9.23
220	240	154	161	Tr260×4	25			AH3148	HM3052	HMV52E	15.9
220	240	189	197	Tr260×4	30			AH2348	HM3052	HMV52E	15.9
320	340	225	234	Tr360×5	33			AHX3168	HM3172	HMV72E	28.1
340	360	167	176	Tr380×5	30	G1/4	9	AOH3072	HM3076	HMV3076E	21
360	380	170	180	Tr410×5	31	G1/4	9.5	AOH3076			22.8
400	420	186	196	Tr440×5	34			AHX3084	HM3088	HMV88E	26.9
440	460	202	213	Tr480×5	37			AHX3092H	HM3096	HMV96E	34
460	480	295	307	Tr500×5	45	G1/4	9	AOH3196	HM31/500	HMV100E	60
510	530	225	235	Tr560×6	54			AHX06/530			47.8
540	560	250	261	Tr600×6	54			AH30/560-1			60.6
560	580	180	190	Tr600×6	47			AH26/580			38
560	580	300	308	Tr620×6	60			AH26/580-1			86